

*Welcome to*  
**Crimson  
Lake**



The striking colours of the setting sun reflecting on the waters is how Crimson Lake received its name. Crimson Lake Provincial Park is a meeting place of foothills forests in the west, bog and muskeg in the north and aspen parkland in the east. Visitors can enjoy a variety of outdoor experiences, abundant wildlife such as moose and deer, and the solitude of dense evergreen forests.

Just over two hours southwest of Edmonton, the park is home to an array of vegetation, flora and fauna. Crimson Lake's recreational activities include: boating, water skiing, windsurfing, canoeing, swimming, hiking, biking and cross-country skiing.

Five prehistoric sites have been identified within the park, featuring flakes, firecracked rock, and raised dunes.



*... the Perfect Destination*

## Summer Activities

### Camping

The park's 169-unit campground on Crimson Lake is equipped with showers, washrooms, firewood, a playground, boat launch and sewage disposal. Sixty-two of the park's campsites have power hook-ups and there are two wheelchair-accessible sites (paved and adjacent to the shower building). There's laundry service at the wash house in Loop A.

There are private group use areas at both Crimson Lake and Twin Lakes that are ideal for school groups, family gatherings and other special events. Available by reservation only (403-845-2330).



### Trails

The park's unique habitat makes it an ideal location for day hiking. Amerada Trail encircles the entire lake. For the more adventuresome, try the trail that goes from Crimson Lake through to Twin Lakes and on into the town of Rocky Mountain House. All hiking trails are gravel surface.

## Winter Activities

Cross-country skiing - Crimson Lake's trail system is used year round. In the winter, trails are groomed for cross-country skiing; 10 km groomed; 10 km ungroomed.

Ice fishing - ice fishing at Twin Lakes for rainbow trout.

## Wildlife Viewing

Wildlife species in the Crimson Lake area include: beaver, moose, red squirrel, shrew, mule deer, white-tailed deer, black bear and cougar.

### Birding

The park supports populations of sandhill cranes, boreal owls, northern pygmy-owls, greater yellowlegs, western tanager and solitary sandpipers.

### Be Bear Aware!

Black bears frequent the park during summer months so visitors are advised to take necessary precautions such as securing food and properly disposing of garbage. For information about bear safety consult a park conservation officer, or pick up a copy of our bear safety brochure "Bear in Mind".



## Things to Know

- Deposit bottles, cans and juice boxes at the recycle bins located at garbage stations.
- Do not leave garbage and food items in your firepit.
- Pick up that extra piece of litter or two.
- Secure your belongings at your campsite.
- If you decide to extend your stay (in a non-reservation site), please renew your permit by noon of the original departure date.
- All pets must be kept on a leash; pets are not permitted on the beach, nor are they allowed in the designated swimming area.
- If you have visitors to your campsite, they must leave the campground by 11:00 p.m.
- **Quiet time** is 11:00 p.m. - 8:00 a.m.  
If you have a noise complaint, contact the campground host or park staff at 845-8585 or call the RCMP at 911.
- Firewood sales are daily from 9:00 a.m. to 10:00 p.m. (delivery available; please inquire at registration office).
- Cutting weiner sticks from, and placing axes in, live trees can kill a tree and may result in a fine.





# Crimson Lake - Winter Trails

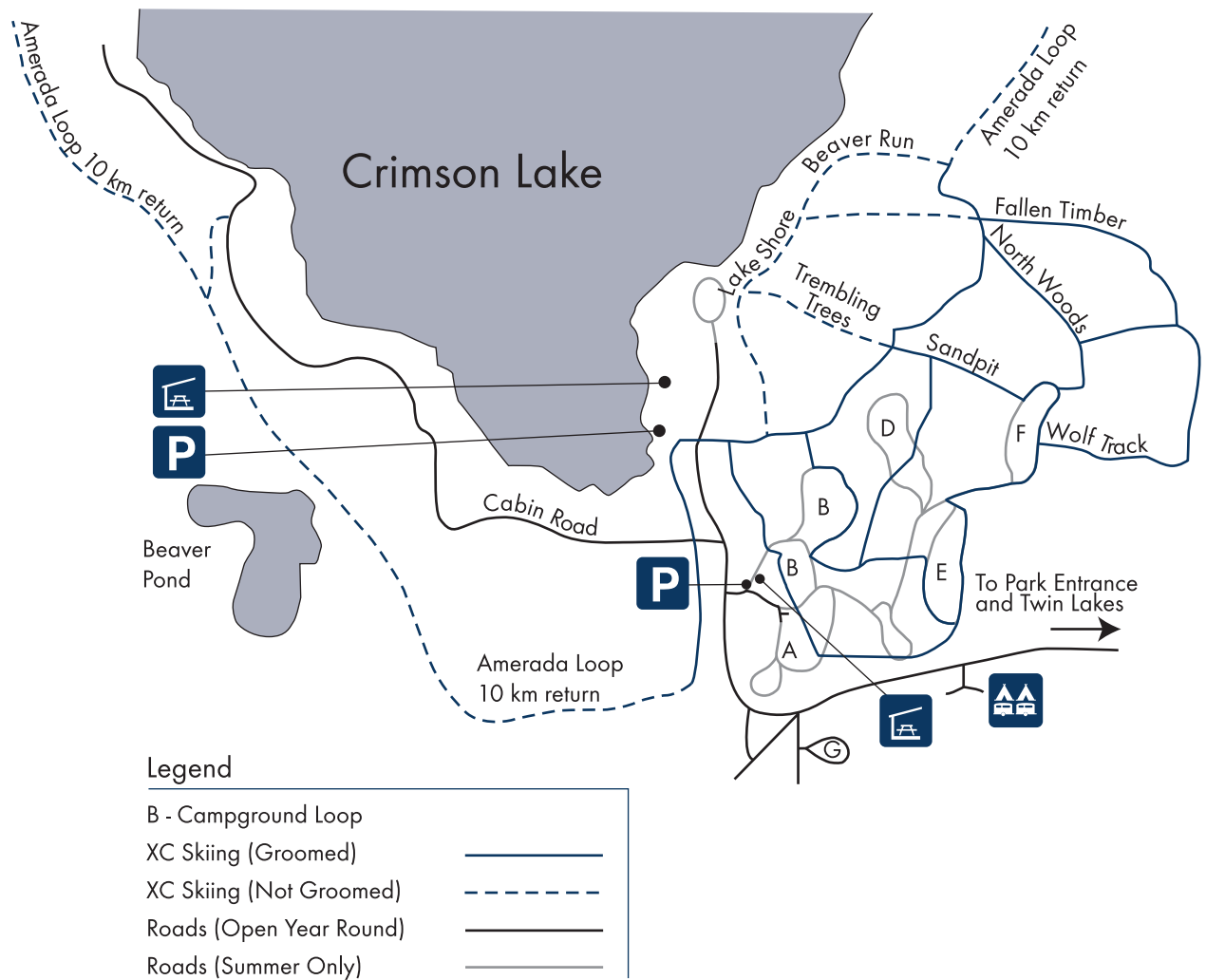

# Crimson Lake - Summer Trails

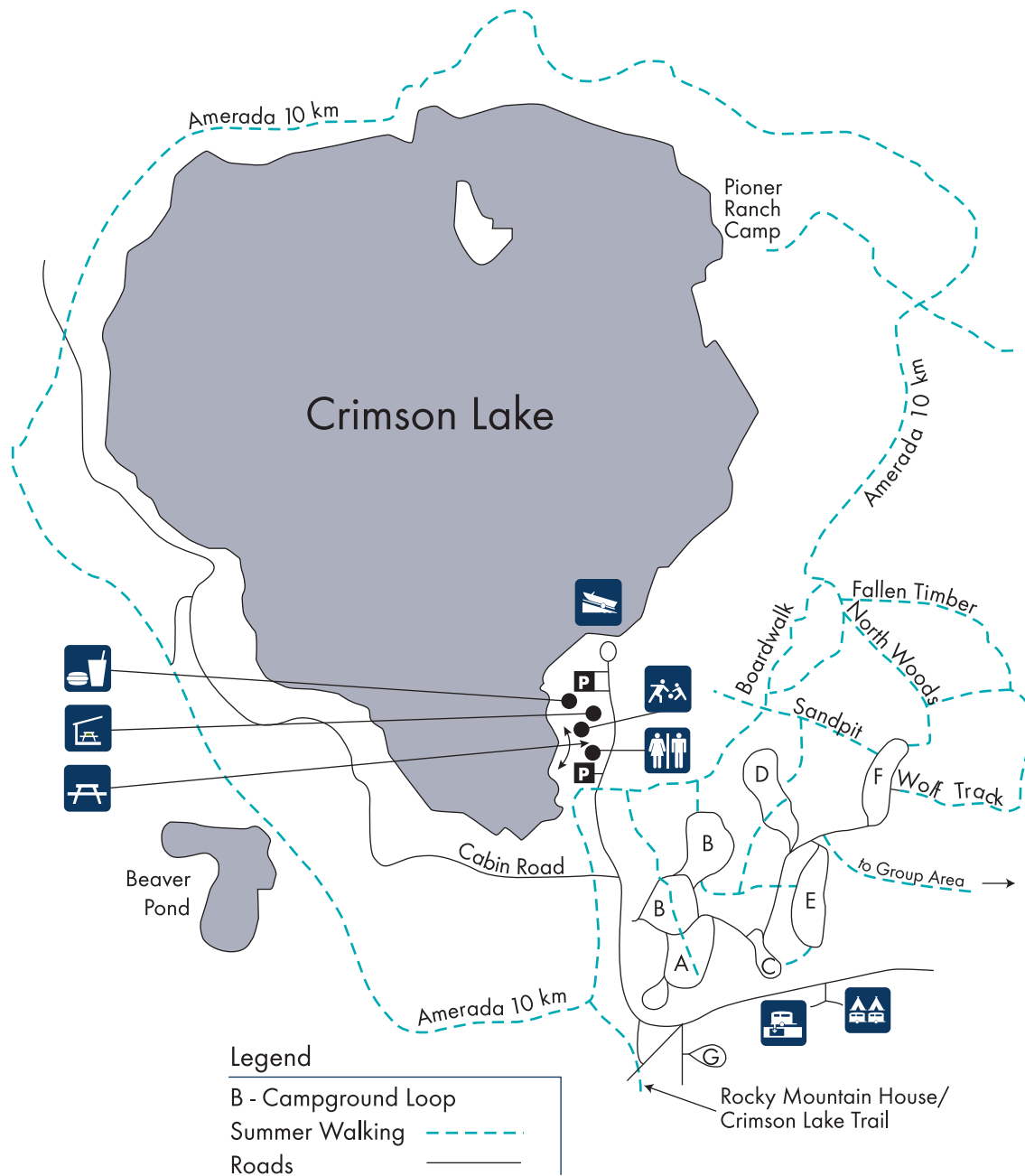

# Crimson Lake Campground

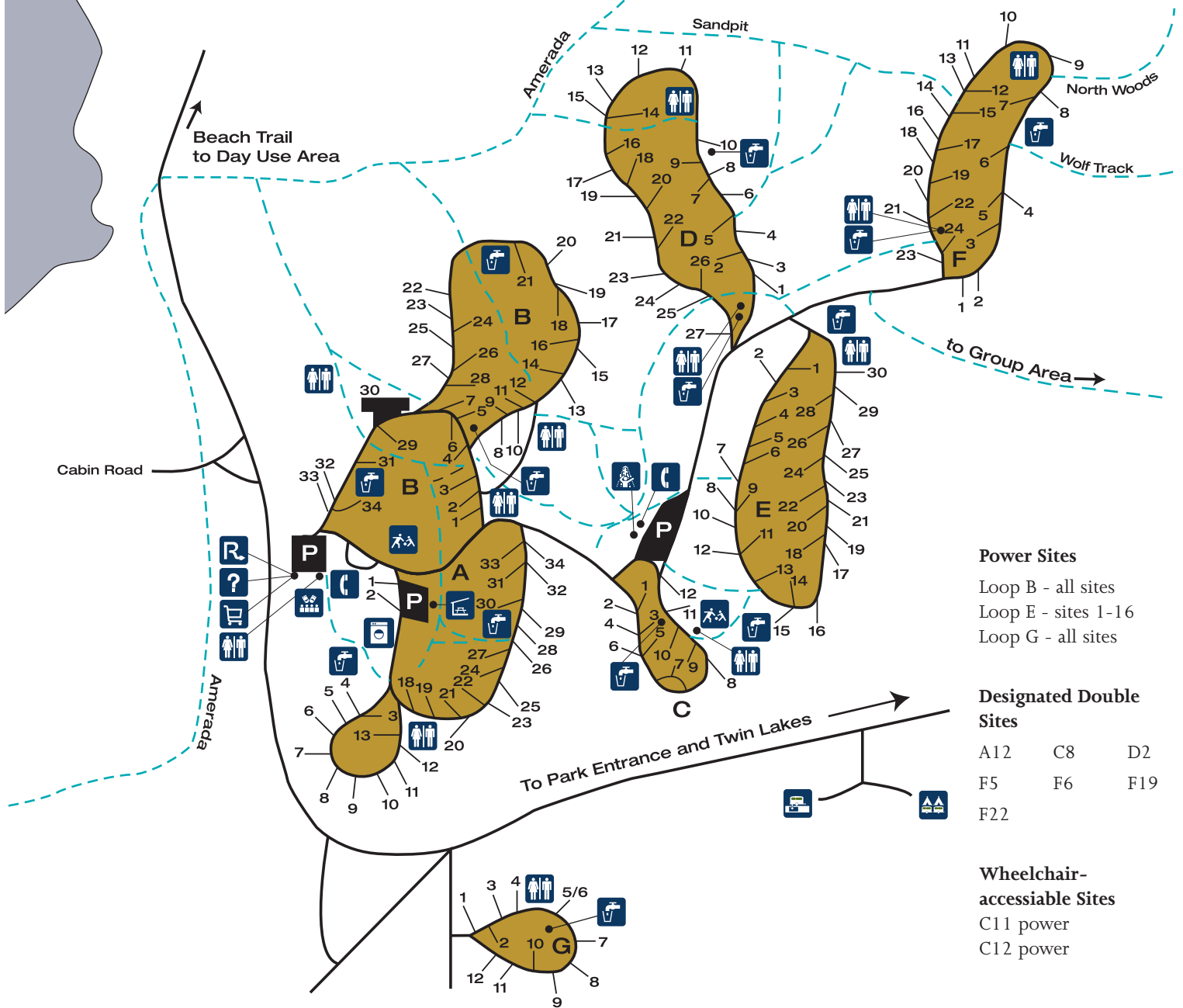

## Power Sites

Loop B - all sites  
 Loop E - sites 1-16  
 Loop G - all sites

## Designated Double Sites

A12    C8    D2  
 F5    F6    F19  
 F22

## Wheelchair-accessible Sites

C11 power  
 C12 power

- |              |                  |                |              |           |
|--------------|------------------|----------------|--------------|-----------|
| Amphitheatre | Firewood         | Laundry        | Playground   | Store     |
| Boat Launch  | Group Camping    | Parking        | Registration | Telephone |
| Camping      | Hand Boat Launch | Picnic         | Sewage Dump  | Washrooms |
| Concession   | Information      | Picnic Shelter | Shower       | Water     |

## For More Information

For campsite or group camping reservations:  
phone 403-845-2330.

For information about other provincial parks and  
protected areas, call 780-427-3582 (toll-free  
1-866-427-3582), or visit our website at  
[www.albertaparks.ca](http://www.albertaparks.ca)

## Where Are We?

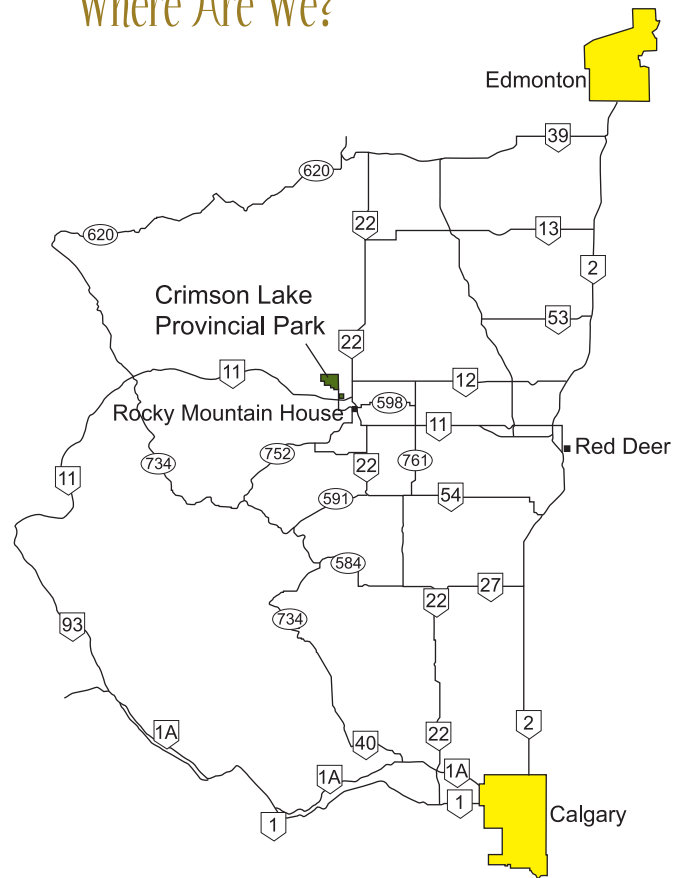

Enjoy Your Stay at Crimson Lake Provincial Park!